

The Tarah Deluxe

BY MAJESTIC CUSTOM HOMES



ELEVATION "A"

Standard 4-Car Garage Shown

(Additional Garage Bays Optional)



ELEVATION "B"

Shown with optional extended
master

Main Level= 2,238 sq. ft.

Lower Level= 2,132 sq. ft.

Total= 4,370 sq. ft.

Plan Features:

- ▶ 4 Car Garage Standard
- ▶ 5 Bedrooms
- ▶ 3.5 Baths
- ▶ Open Floor Plan
- ▶ Formal Dining Room



For more information call:

Jordan at 281-900-7020

Builder Direct: 719-492-0685



The Tarah Deluxe

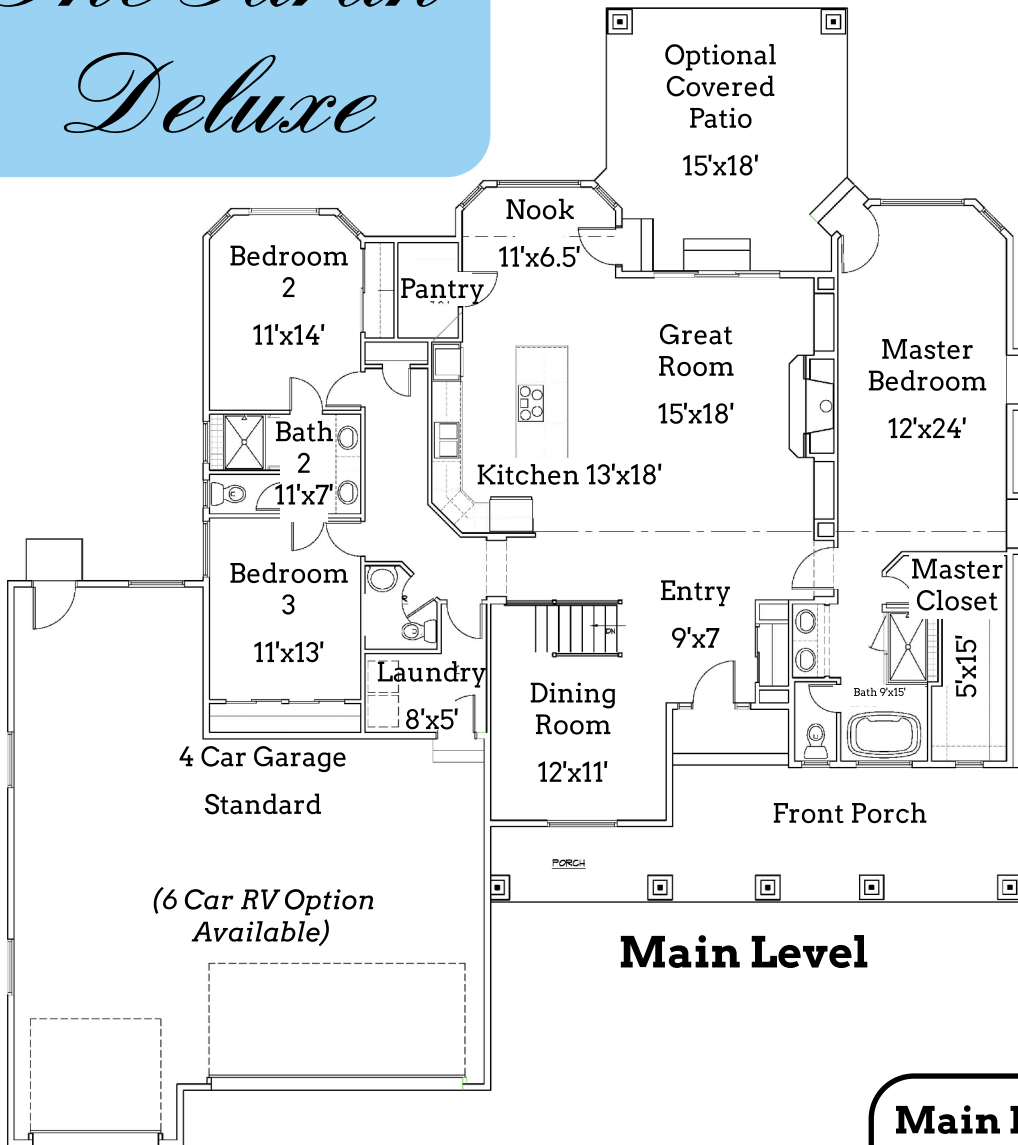

Main Level

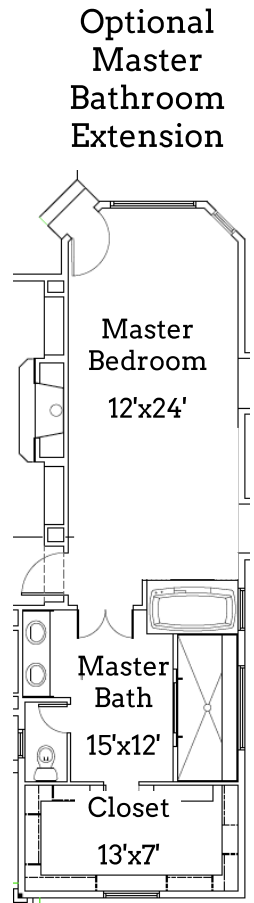

Main Level= 2,238 sq. ft.
Lower Level= 2,132 sq. ft.
Total= 4,370 sq. ft.

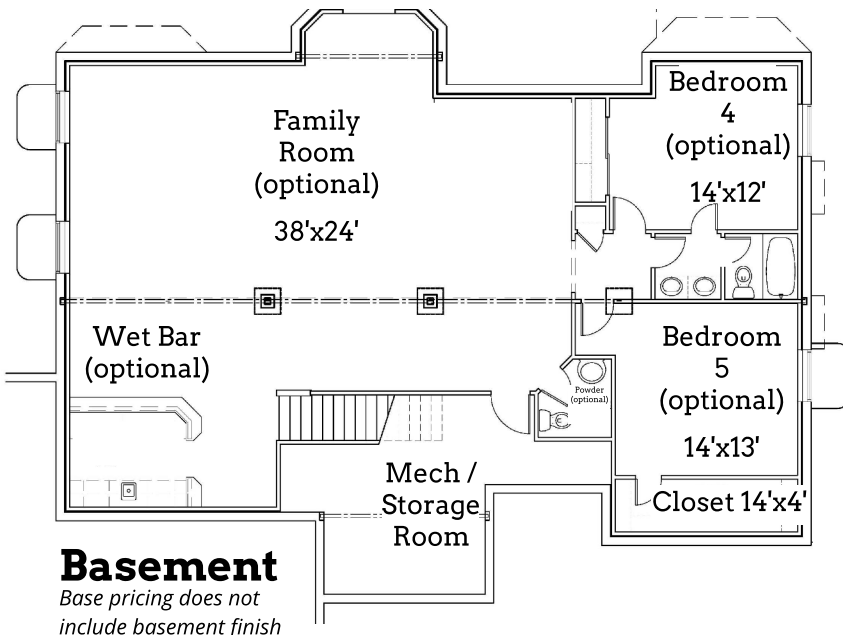

Basement

Base pricing does not include basement finish

